

# FTL400 - RHS

PLEASE CHECK A BOX IF THE HANDING IS DIFFERENT THAN SPECIFIED IN TITLE ex. (SR9000FV-D)

- D = DOUBLE
- RHS = RIGHT HAND SINGLE
- LHS = LEFT HAND SINGLE

## SPECIFICATION

The FLT400 door panel is constructed with food grade approved 2 ply belting material that is abrasion resistant. Total door thickness of 0.240" and reinforced hinge pocket. It operates on the top mounted only Eliason gravity hinging system.

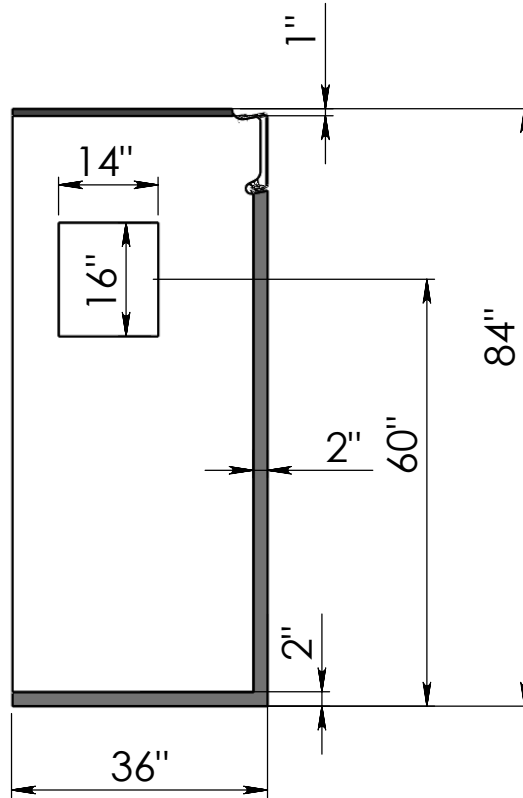

ALL MEASUREMENTS ARE IN INCHES

QUANTITY: 1  
FINISHED OPENING SIZE:  
36 W X 84 H  
REGULAR

DOOR COLOR:  
GREEN

WINDOW: 14 W X 16 H  
FLEXIBLE PVC

GASKETS: FULL

Approved By:

Signature:

TAG:



Ph: 800-828-3655  
Fx: 800-828-3577  
[www.eliasoncorp.com](http://www.eliasoncorp.com)

**PROPRIETARY AND CONFIDENTIAL**  
THE INFORMATION CONTAINED IN THIS DRAWING IS THE SOLE PROPERTY OF CMI DOORS. ANY REPRODUCTION IN PART OR AS A WHOLE WITHOUT THE WRITTEN PERMISSION OF CMI DOORS IS PROHIBITED.

PROJECT:

P.O.#

SOLD TO:

ACK#